

TYPE "B" STYLE
 JUNIOR DESK CUT PATTERN
 11/24/09

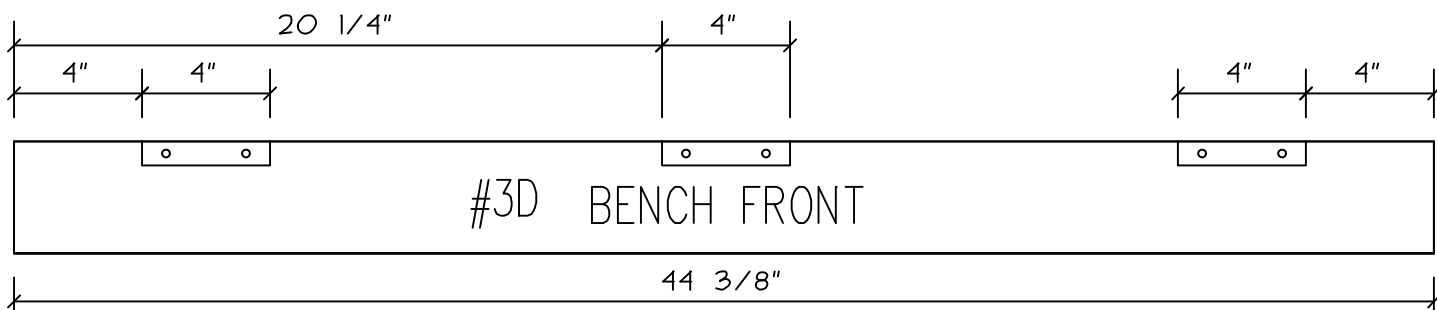

TYPE "B" STYLE
 JUNIOR DESK PARTS
 11-24-09

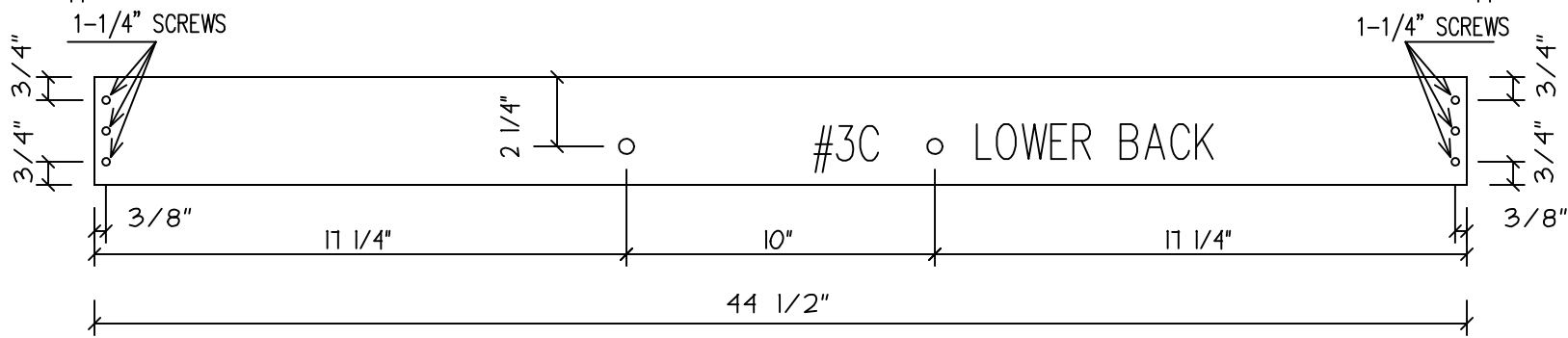
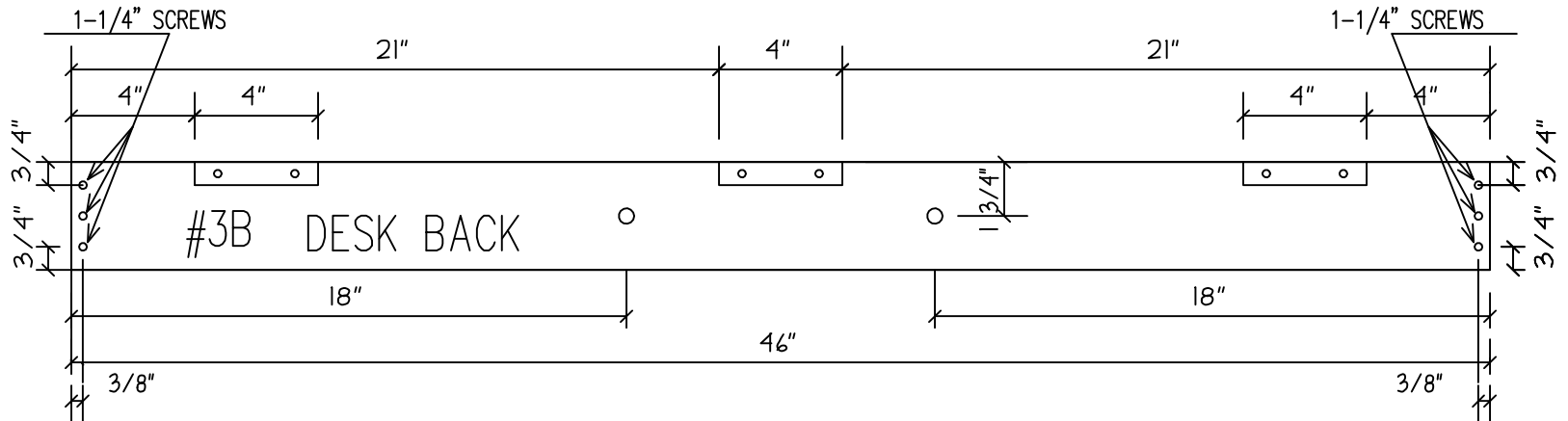
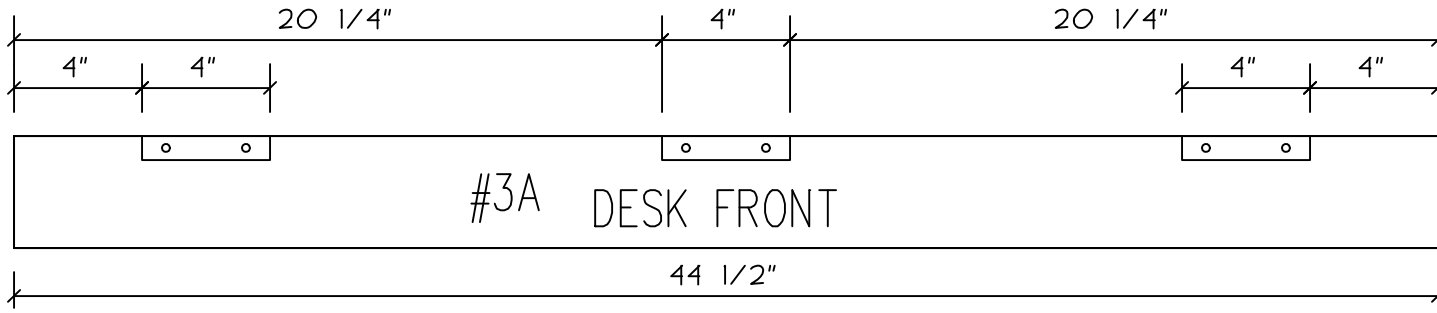
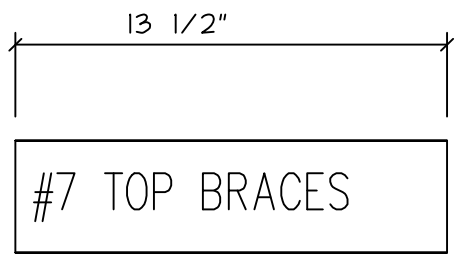
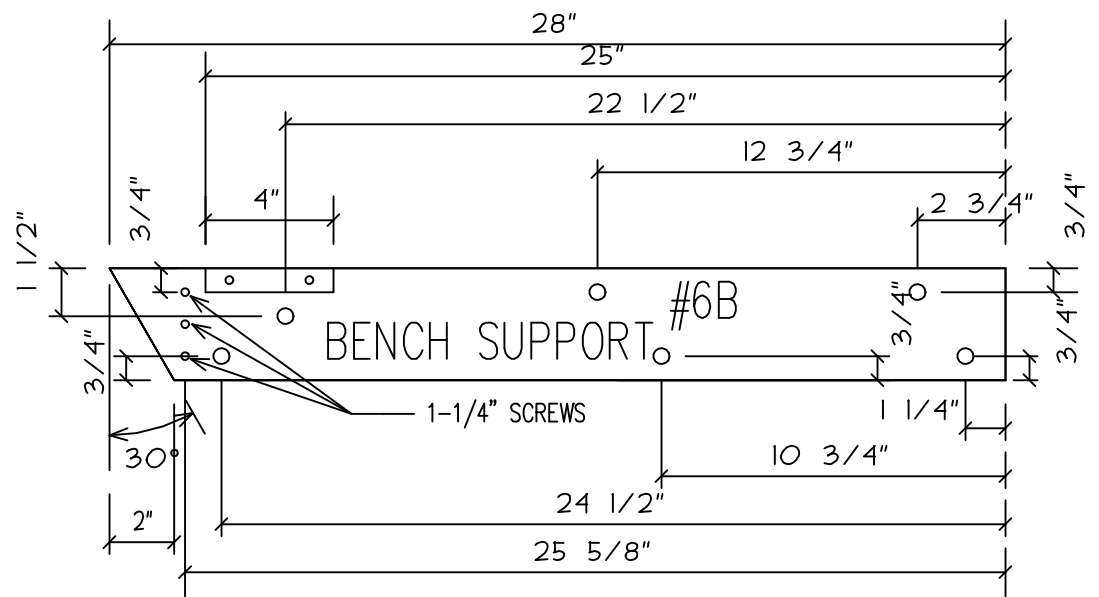
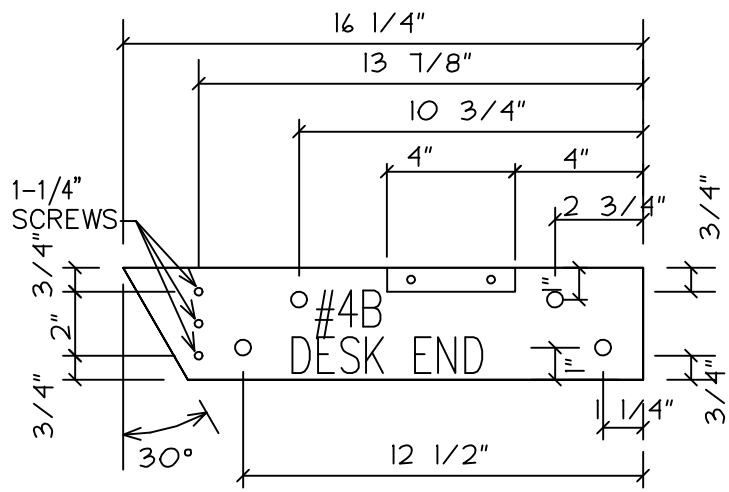
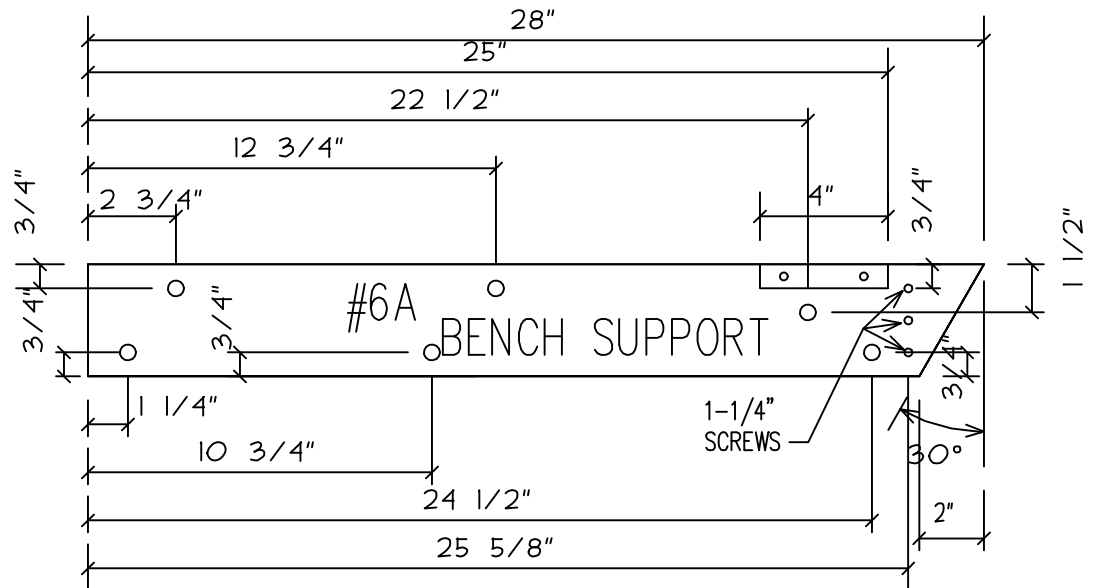
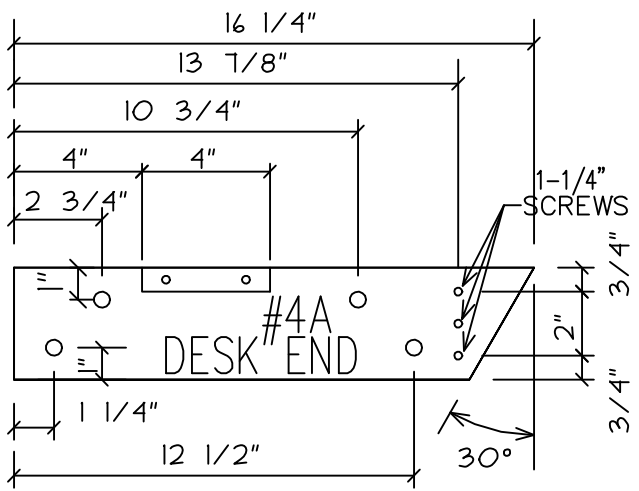

2 REQUIRED

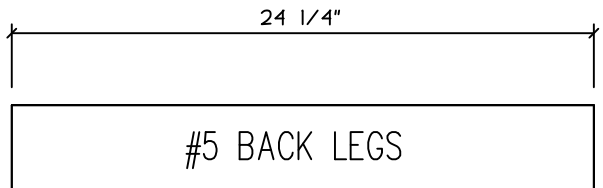

2 REQUIRED

TYPE "B" STYLE
JUNIOR DESK PARTS
11-24-09

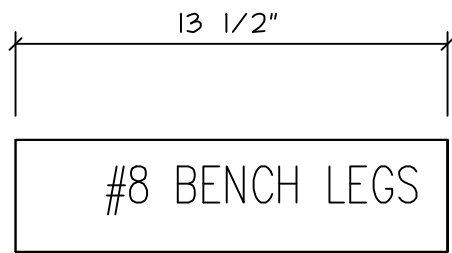

2 REQUIRED

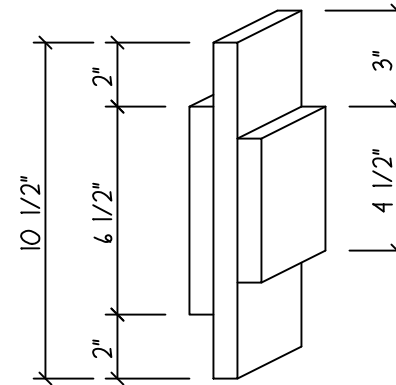
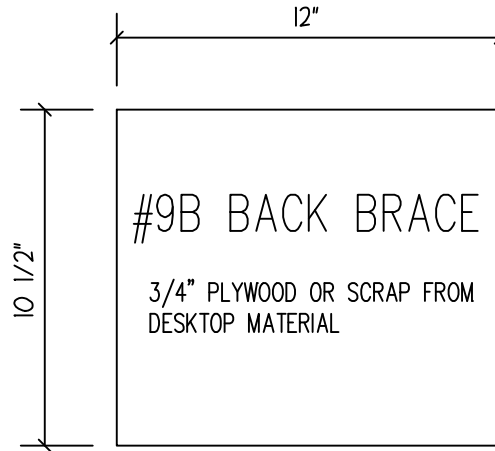

JIG FOR SPACING BOARD (2 NEEDED)
USE 3/4" x 1-3/4"

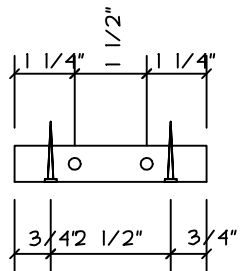

13 - 3/4" x 3/4" x 4" BLOCKS
FOR #6 x 1-1/4" DRYWALL TYPE SCREWS
DRILL 9/64" PILOT HOLES AND
COUNTER SINK TO PREVENT SPLITTING.
DRILL 5/64" PILOT HOLES IN DESK &
SEAT BOTTOMS, MAX 1/2" DEEP.

TYPE "B" STYLE
JUNIOR DESK PARTS
11-24-09

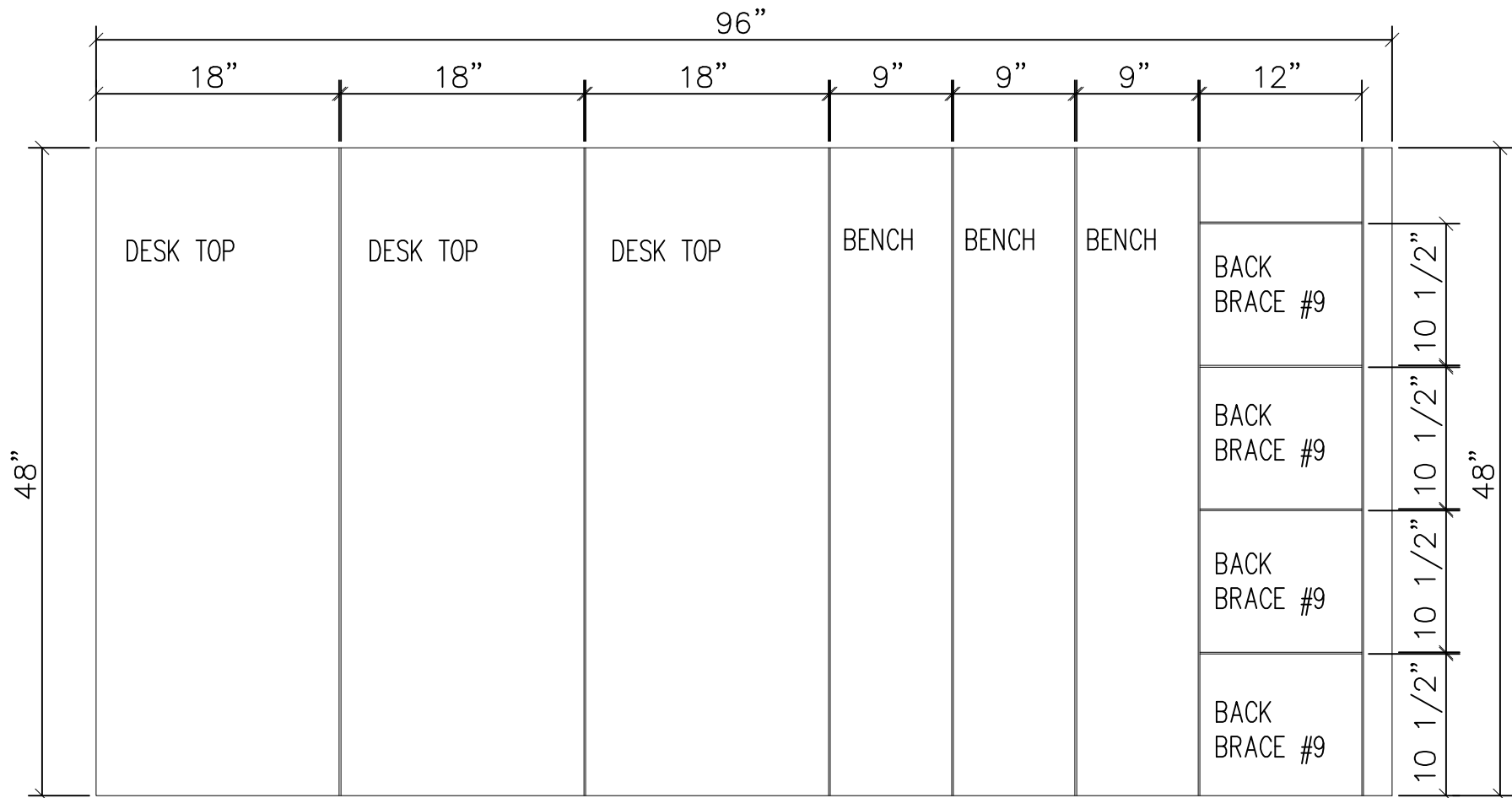

Cutting Diagram for 3/4 inch Plywood

TYPE "B" STYLE
 JUNIOR DESK CUT PATTERN
 11/24/09

TYPE "B" STYLE JUNIOR SCHOOL DESK MATERIAL LIST

Each desk will require three 1x4 (3/4" x 3-1/2") x 8 foot boards and one 1x4 (3/4" x 3-1/2") x 10 foot board to be cut as follows:

- | | | |
|--------------------|----------|---------|
| 1. 10'x1"x4" board | | |
| PART # | QUANTITY | LENGTH |
| #6 | 2 pieces | 28" |
| #3A | 1 piece | 44-1/2" |
| #7 | 1 piece | 13-1/2" |
| 2. 8'x1"x4" board | | |
| #5 | 1 piece | 24-1/4" |
| #4 | 2 pieces | 16-1/4" |
| #8 | 2 pieces | 13-1/2" |
| 3. 8'x1"x4" board | | |
| #3B | 1 piece | 46" |
| #3C | 1 piece | 44-1/2" |
| 4. 8'x1"x4" board | | |
| #7 | 1 piece | 13-1/4" |
| #5 | 1 piece | 24-1/4" |
| #3D | 1 piece | 44-3/8" |

Each desk will require one(1) 18"x48"x3/4" plywood desk top and one (1) 9"x 48"x 3/4" plywood desk bench and one (1) 10-1/2"x12"x3/4" plywood back brace. Note: one (1) sheet of 3/4"x 4ft x 8ft plywood will make three (3) desks.

Round over the top and bottom edges of the desk top and bench (the bottom back edge of the desk top does not need to be round over.) Sand any rough ends and edges of all exposed parts.

Each desk will also require:

1. 13 - 3/4"x 3/4"x 4" cleats which can be made from the excess 1x4's.
2. 24 - carriage bolts, 1/4" x 2" with nuts, lock-washers and washers.
3. 76 - #6 x1-1/4"drywall screws
4. Two or three coats of polyurethane finish.
5. One - quart zip-lock bag for the loose hardware (bolts, washers, nuts & screws).

#2 or better pine finished four sides works well and requires minimal sanding. Attached is a drawing with a layout of the cut list. The excess 1x4 material can be used to make the 3/4"x 3/4"x 4" blocking to secure the bench and top to the frame.

TYPE "B" STYLE
JUNIOR DESK MATERIAL LIST
11/24/09